

UC CACC MA 01 6C V1

LJ6C Flat Single Adaptor 38 x 25

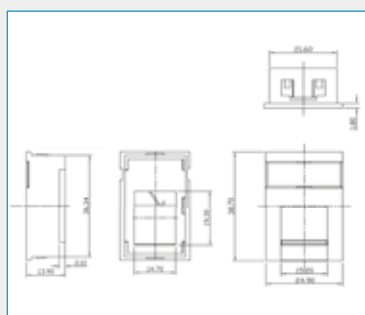

Technical data

Product code	Product name / Description	Measures	Weight	Items per packaging unit
		Mm	g	
YPMAP01842	UC CACC MA 01 6C V1 LJ6C Flat Single Adaptor 38 x 25	38 x 25	4.3	1 or 50

Related Products

YFPBP01840	UC CACC FP 01 6C V1 Single port UK frame 86 x 86 (LJ6C Type)	86 x 86	23	1 or 50
YFPBP01841	UC CACC FP 02 6C V1 Dual port UK frame 86 x 86 (LJ6C Type)	86 x 86	23	1 or 50

UC CACC AA 01 6C V1

LJ6C Angled Single Adaptor 38 x 25

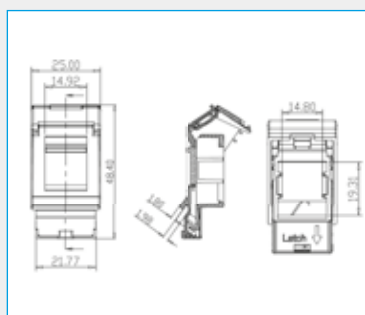

Technical data

Product code	Product name / Description	Measures	Weight	Items per packaging unit
		Mm	g	
YAABP01691	UC CACC AA 01 6C V1 LJ6C Angled Single Adaptor 38 x 25	38 x 25	23	1 or 50

Related Products

YFPBP01840	UC CACC FP 01 6C V1 Single port UK frame 86 x 86 (LJ6C Type)	86 x 86	23	1 or 50
YFPBP01841	UC CACC FP 02 6C V1 Dual port UK frame 86 x 86 (LJ6C Type)	86 x 86	23	1 or 50